



HKC-HA Series Hall Effect Current Sensor

The HKC-HA series current sensor is an open loop device based on the measuring principle of the Hall Effect, with a galvanic isolation between primary and secondary circuit. It provides accurate electronic measurement of DC, AC or pulsed currents.

ELECTRICAL DATA

	HKC800HA	HKC1000HA	HKC2000HA	HKC3000HA	HKC5000HA	
Rated Current	800	1000	2000	3000	5000	A
Measure Range	1600	2000	3000	4500	7500	A
Rated Output					4±1%	V
Supply Voltage					+15±5%	V
Offset Voltage					≤ +15	mV
Magnetic Offset Voltage					≤ ±30	mV
Offset Voltage Drift					≤ +0.5	mV/°C
Linearity					≤ ±1	%FS
Response Time					≤7	μS
Galvanic Isolation					6	KV
Operating Temperature					-20~+70	°C
Storage Temperature					-40~+85	°C

MUTING DIMENSIONS(FOR REFERENCE ONLY)

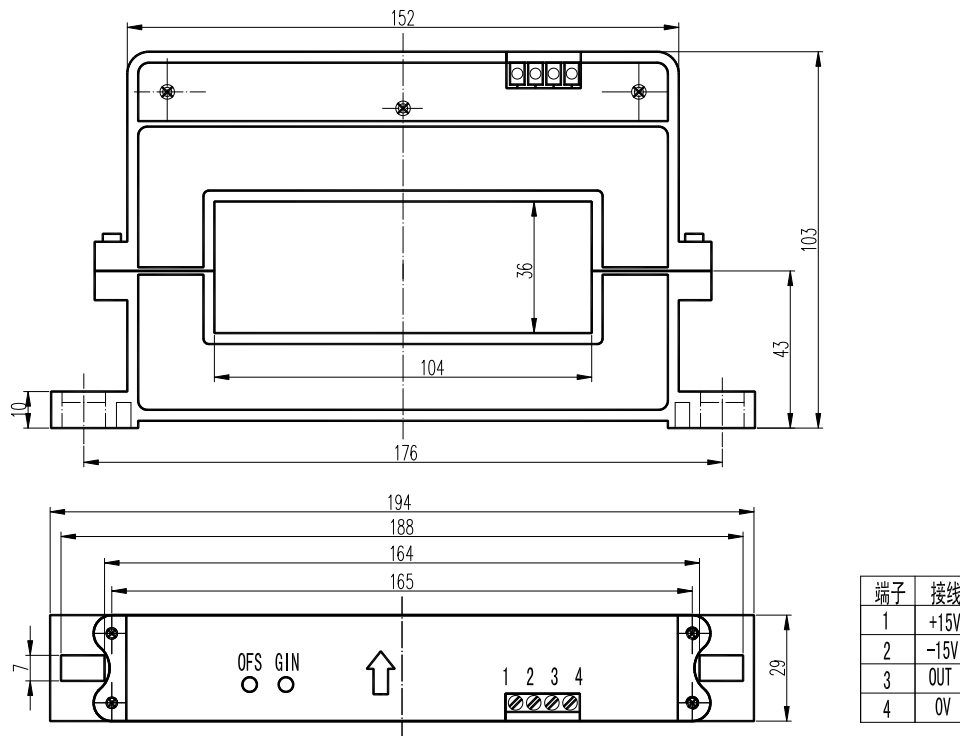

INSTRUCTIONS FOR USE

1. When the current will be measured goes through a sensor, the voltage will be measured at the output end. (Note: The false wiring may result in the damage of the sensor).
2. The output amplitude of the sensor can be adjusted according to users' requirements.
3. Custom design in the nominal input current and the output voltage available